

INSTALLATION GUIDE

Installation Methods and Steps

WARNING

Before servicing or installing the product, ensure the power supply is disconnected. Adhere to the specified guidelines with a thorough and attentive review for the best results. The quantities of accessories and fixings depend on the type and its effect on the variant being used.

N2-8 Mount Series

LED Neon flex can be fastened to surfaces using the appropriate accessories available.

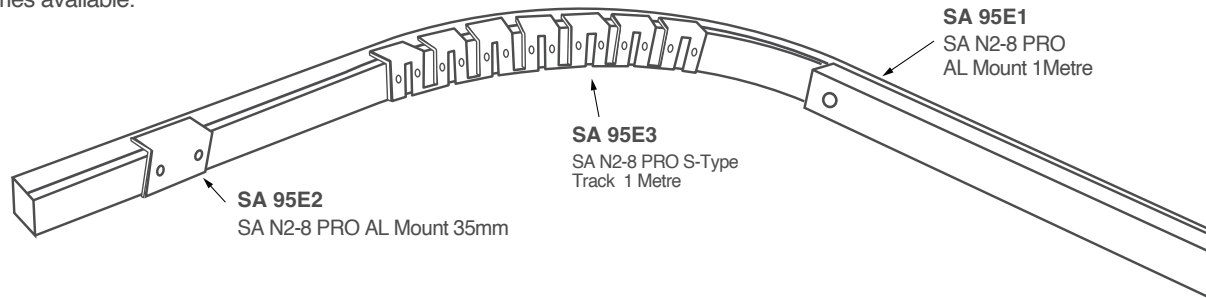

Precautions

Aluminium Mount

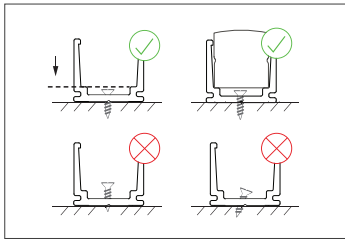

Install the screw ensuring the head is flush or lower than the AL mount and screwed it into the surface straight. (Designed to leave space at the bottom for screws.)

S-type Track Mount

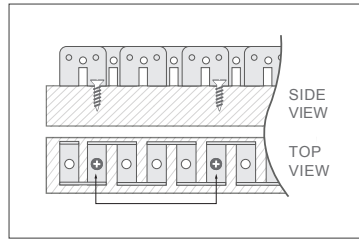

Put screws in any hole along the bendable mount to create the desired curve shape.

***To avoid breakage from repeated shaping, it is recommended to mount in place at once.**

Installation

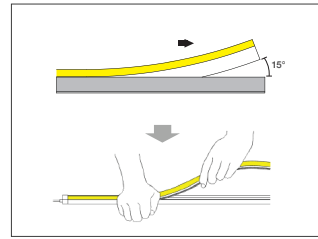

Press the neon flex vertically into the mount with your palm, ensuring it fits snugly and the bending angle remains less than 15° in one direction.

Uninstallation

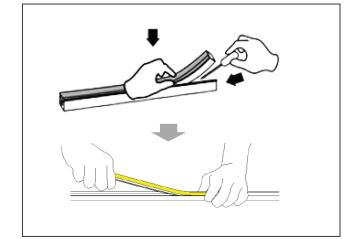

To uninstall, use tools to lift the end of the Neon Flex and then pull it out along the mount while holding both sides.

Mount Installation

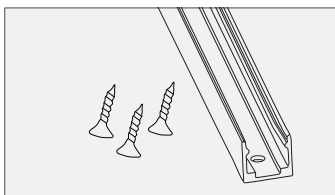

SA 95E1
SA N2-8 PRO AL Mount_1Metre

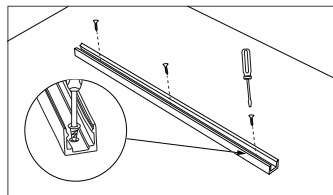

1 Fix the aluminium mount to the place where it needs to be installed by a screwdriver.

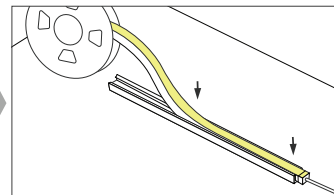

2 Face the light-emitting side up and gently insert into the fixing clip.

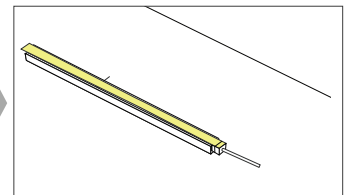

3 Fixed finish, light up with DC power supply.

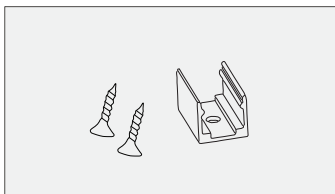

SA 95E2
SA N2-8 PRO AL Mount 35mm

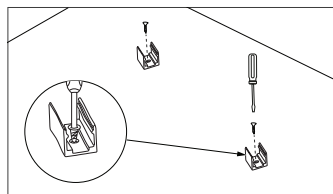

1 Fix the aluminium mount to the place where it needs to be installed by a screwdriver.

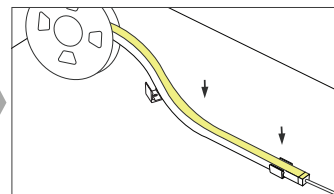

2 Face the light-emitting side up and gently insert into the fixing clip.

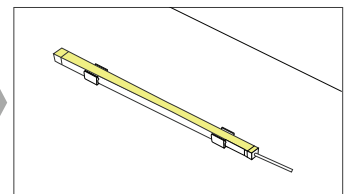

3 Fixed finish, light up with DC power supply.

INSTALLATION GUIDE

Installation Methods and Steps

WARNING

Before servicing or installing the product, ensure the power supply is disconnected. Adhere to the specified guidelines with a thorough and attentive review for the best results. The quantities of accessories and fixings depend on the type and its effect on the variant being used.

Mount Installation

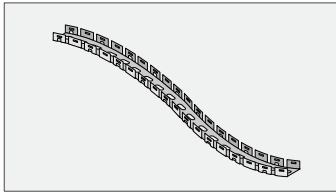

SA 95E3
SA N2-8 PRO S-Type Track_1 Metre

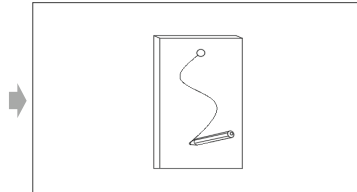

1 Mark the required shape on the surface or sketch it on.

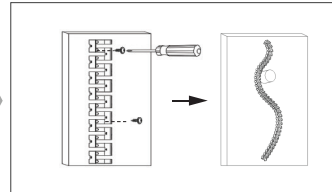

2 Place the track mount along the drawn line and start fixing it with screws from the head.

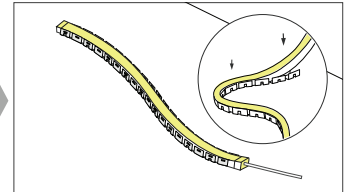

3 Gently bend and insert it into the fixing clip, following the curve. Light up with DC power supply.

N2-8 End Cap Series

End Cap - Outlet Direction



SA 95E5
SA N2-8 PRO End Cap
Straigh Hole

SA 95E4
SA N2-8 PRO End Cap
without Hole

SA 95E6
SA N2-8 PRO End Cap
Side & Bottom Hole

Cutting and Soldering Installation

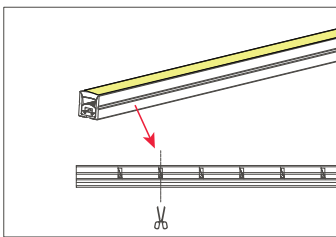

1 Find the designated cutting position on the neon and cut it in the middle.

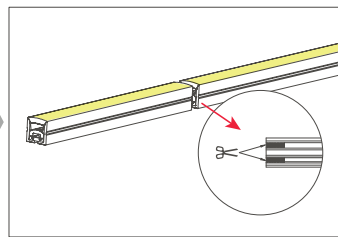

2 Use the cutter to create two notches, 3.5mm wide and 6mm long, at the cutting position on the bottom of the neon flex, exposing the bare copper wires inside the neon.

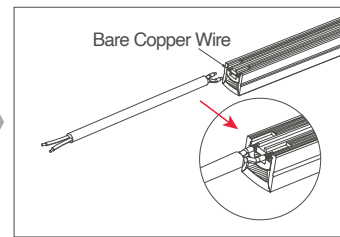

3 Carefully solder the wire to the bare copper wires.

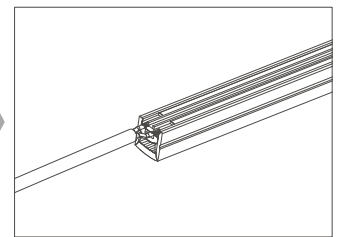

*You can choose the final design, such as an end cap with a straight hole or an end cap with side and bottom holes, please see the following steps.

Finish with End Cap Installation

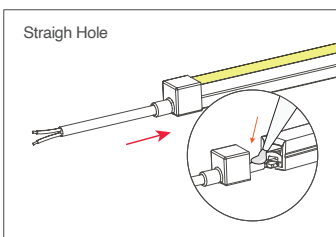

Put silicone glue inside the plug, and push the end cap into the neon.

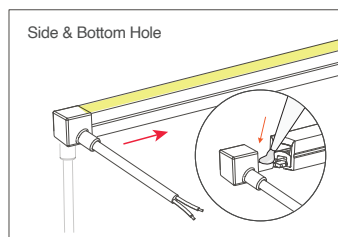

Put silicone glue inside the plug, and push the end cap into the neon.

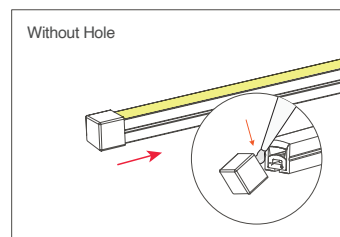

Put silicone glue inside the end cap, and push it into the neon flex.